



The Charolais Pavilion,
Avenue M,
Stoneleigh Park, Kenilworth,
Warwickshire, CV8 2RG
t: 024 76 697731
f: 024 76 697776
www.rugbyfarmersmart.com
Holding No. 43-139-8013

Office Hours: Monday to Friday – 9.00am to 5.00pm
Opening Time: Gates open at 5.30am until further notice

Market Reports For Monday 13th June 2016

Market At A Glance

Prime Steers to 212p/kg & £1315
Prime Heifers to 206p/kg & £1178
Prime Lambs to 221p/kg & £101
Prime Lamb SQQ 188p/kg
Hoggs to 184p/kg & £95
Hogg SQQ to 167p/kg
Cull Ewes to £106
Calves to £270

Calves

Calves will be sold at 10am prompt prior to the fat lambs.

Catalogues & Entry Forms available by post, email or on the website
www.rugbyfarmersmart.com ~ admin@rugbyfarmersmart.com

CATTLE: 25 forward**Prime Cattle: 13 forward**

Very few about this week as farmers turned to field work. Trade though swift enough for those with quality and those out of spec sorts, today looking a smart price.

In the Steers a nice Blonde Steer from Messrs Baylis Partners to 212p/kg and £1315 whilst heavy Steers from T E Barnacle & Son to 174p/kg with weight. Heifers short on quality today and Butchers demand not fulfilled. Nice meat from Parrry Walters and Martin Baylis selling to 206 & 205p/kg with meated Heifers from B T Caswell looking a good shot at 196p/kg.

Auctioneer: Tom Wrench

STEERS: 6			
Top prices per head			
Blonde x	620kg	£1315	JB Baylis & Partners
Charolais x	775kg	£1310	TE Barnacle & Son
Charolais x	712kg	£1268	TE Barnacle & Son
Charolais x	640kg	£1114	TE Barnacle & Son
Hereford x	618kg	£1075	D P Jones Agricultural
Top prices per kilo			
Blonde x	620kg	212p/kg	JB Baylis & Partners
Charolais x	712kg	178p/kg	TE Barnacle & Son
Limousin x	618kg	174p/kg	DP Jones Agricultural
Charolais x	640kg	169p/kg	TE Barnacle & Son
Charolais x	775kg	166p/kg	TE Barnacle & Son

HEIFERS: 6			
Top prices per head			
Limousin x	571kg	£1177	DTP & PA Walters
Limousin x	584kg	£1145	B T Caswell
Charolais x	550kg	£1128	J B Baylis & Partners
Limousin x	633kg	£1070	DTP & PA Walters
Charolais x	586kg	£1045	B T Caswell
Top prices per kilo			
Limousin x	571kg	206p/kg	DTP & PA Walters
Charolais x	550kg	205p/kg	J B Baylis & Partners
Limousin x	584kg	196p/kg	B T Caswell & Son
Charolais x	586kg	178p/kg	B T Caswell & Son
Limousin x	633kg	169p/kg	DTP & PA Walters

Cows: 7 forward

All grade 3 Cows at best today looking a good trade but almost all not Farm Assured and vendors giving away money on each and every non Assured Beast. Non Assured Cows from Sam Sensecal sold to 128p/kg and others 122 and 121p/kg. Over fat Cows to 115p/kg for those that would hit a 5 on the grid.

Auctioneer: Tom Wrench

Calves : 13 forward

A few less forward today. Top price for MJ Sharlot of £270 for a smart 5 week old Simmental x Bull. Top of the Heifers a British Blue x from the same home to £150. Native crosses to £60 for Sussex x Bulls with sisters to £50. More Calves needed each and every week.

Please not the earlier start time of 10am for Calves

Auctioneer: Tom Wrench

SHEEP: 3,529 forward

Spring Lambs: 2,880 forward SQQ 188p/kg

The seasonal drop today right on que. Numbers out across the land and reports of poor continental sales leading to lethargy in buyers requirements today. That said anything with quality still selling well over 200p/kg and today a greater proportion of leaner and underfinished lambs. An SQQ of 188p/kg one of the highest for the day and an indication of the numbers out across the country. In the Euro Spec a top of 221p/kg for Dave Mitchell with 39kg whilst Martin Woodward 218p/kg for equal weights whilst D Mitchell 217p/kg for 42kg. In the heavies R J Batchelor 188p/kg for 48.5kg whilst FJ Tombs & Son 187p/kg twice for 46.5 kg. In the lump a top for the Euro lambs at £91 for 42kg for D Mitchell, £87 for 43kg Texels from Julian White and equal money for 45kg for RM Seckington & Son. Overall a top of £101 for 58kg for WG & SW Jones with 58kg whilst D Mitchell £95 for 54kg. S Brodie and J Jeyes both £93 at 51 and 53kg. Trade likely to be at this level for the next few weeks and then of course the Referendum and the end of the Ramadan festival will dicatate the way ahead.

Auctioneer: Tom Wrench

Prime Lambs: SQQ (188.6p/kg)			
Per kilo			
Beltex	39.00 kgs	221p/kg	D Mitchell
Charollais x	30.00 kgs	218p/kg	Woody
Beltex	42.00 kgs	217p/kg	D Mitchell
Texel x	40.00 kgs	215p/kg	JS & VM Hiorns
Texel x	40.00 kgs	213p/kg	JS & VM Hiorns
Per head			
Charollais x	58.00 kgs	£101.00	WG & SW Jones
Texel x	54.00 kgs	£95.00	D Mitchell
Charollais x	55.00 kgs	£93.00	S Brodie
Charollais x	51.00 kgs	£93.00	JT Jeyes & Son
Charollais x	51.00 kgs	£91.00	MM Clarke & Son

Prime Hogs: 147 forward Overall Avg 167.33p/kg

All over bar the shouting in relation to numbers left to kill. Trade though marvellous with buyers seemingly having orders for Togs to well outweigh those for lambs. In simple terms the Supermarkets seem to have a job for the Hogs!! Top today £95 shared between Chris Price and Linton Farms with 58kg with even teeth up to £89.

Auctioneer: Tom Wrench

Stores : 111 forward

Two pens of rare breed Store Hogs today, with a top of £61 for C Sander. We now look towards the new crop with Store lambs likely to come about as we look to July.

Auctioneer: Tom Wrench

Breeding Sheep : 47 forward

Just a handful of Breeding Sheep forward, again due to the time of year. Top today a Hogg and lamb from IC & SD Archer to £72 per life, £144 for the outfit. Older Ewes with a pair of lambs from RT Haynes to £64 per life.

Auctioneer: Tom Wrench



AUTO GATES LTD

Bridge Farm, Holt Lane, Ashby Magna, LE17 5NJ

Trevor 07498993897/01455 202791

Email: tjautogate@gmail.com

Fitted to new or existing gates, wood or steel automated.

Sliding, swinging or cantilever.

Cull Ewes : 471 forward

A good show of Ewes with vendors travelling some distance to Stoneleigh. Trade must be reported as very fast with heavy Ewes and lean Ewes easy to sell whilst fat Ewes not currently required. No real Continental shape Ewes on offer today but heavy Suffolks looking a fast trade. Rams top of the tree today with a Texel from T Barber & Son and a pair from S Brodie taking £106 ahead of K Badger at £100 and Will Moore at £99. Suffolks with weight to £95 from David Ofield ahead of DJ Farms at £94 and Messrs Gowling at £91. Mules today to £90 for the odd power house from D Hancock. Whilst N Sheppard sold his Mules to £89.

Auctioneer: Tom Wrench

Cull Ewes & Rams: 471 forward					
Texel	£106.00	T Barber & Son	Suffolk	£95.00	D Ofield
Charollais	£106.00	S Brodie	Suffolk	£94.00	DJ Farms
Texel	£100.00	K Badger	Suffolk	£92.00	GJ & SL Gowling
Texel	£99.00	W G Moore	Suffolk	£91.00	CBE Price
Suffolk	£95.00	G Bell	Texel	£91.00	GJ & SL Gowling

M & M Shearing Services

Shearing, Crutching, Bellying & Winter Shearing.
All areas.
Matt Warren 07852 974055

Land Available for Mowing and/or Grazing

• **23.10 Acres Longdown Lane, Barby**

- Suitable for cattle & sheep grazing
- Mains water, fed to water troughs
- Cattle holding pen
- Roadside access
- (will need electric fence if sheep)

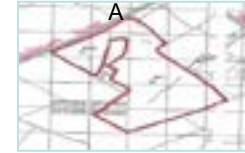

• **11.19 Acres Berryfield Way, Long Bucky**

- 2.58 acres grazing only
- 8.61 acres grazing & mowing
- Mains water, fed to water troughs
- (will need electric fence if sheep)



• **31.14 Acres Welford**

- Sheep grazing only
- Natural Water Source
- Good roadside access
- River Meadows

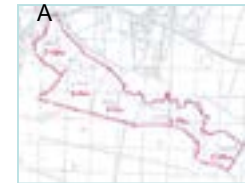

• **16.19 Acres Hill Farm, Galley Common**

- Mowing only
- Good road access



• **19.50 Acres Radbourne Lane, Ladbroke**

- Cattle Grazing only
- Ridge & Furrow
- Mains Water fed to water troughs



• **Up to 150 Acres Monks Kirby**

- 2nd Cut Silage
- Sheep Grazing

For more information please call Jennifer Whitton
or Emily Powell on 01788 564680

Telephone: 01788 564749

7 – 11 Albert Street, Rugby, CV21 2RX

Email: dispersal.sales@howkinsandharrison.co.uk

Have Wool?

Laurence Pierce (Wool Merchants)

One of Irelands largest and best known wool buyers require
2016 wool clips.

Please contact your local agent:

Mr Steve Eales, Brookhill Farm, Peatling Magna, Leicestershire
Tel: 07732 213278

Wool sheets are now available
Speedy payment in full

COMBS AND CUTTERS SHARPENED ALSO CONTRACT SHEARING

Call: Steve Wagstaff on 07775 628483

Goodmans Slaughterers Ltd

Licensed Slaughterers
Collectors of all Fallen Stock
Registered with NFSCO
Telephone: 01789 740240
Tom: 07966 226141

FARM INSURANCE WHERE YOUR OFFICE IS OUR OFFICE

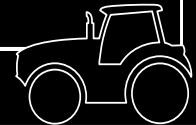

We believe it's better to take the time
meeting face to face on a farm, not around a
desk.

Call 02476 444519 for a quote or pop in
NFU Office, Meridian House , 6 Eastwood
Business Village, Harry Weston Road, Binley
Business Park, Coventry, Warwickshire CV3 2UB



NFU Mutual
INSURANCE | PENSIONS | INVESTMENTS

It's about time®

Agent of The National Farmers Union Mutual Insurance Society Limited. For
security and training purposes, telephone calls may be recorded and
monitored.



On Instructions from Messrs R Baker & Sons

(Due to retirement of two partners and restructuring of the business)

Grange Farm, Bruntingthorpe, Lutterworth, Leicestershire, LE17 5QG

Genuine Dispersal Sale Of

219

**HOLSTEIN FRIESIAN HOMEBRED DAIRY COWS,
IN CALF HEIFERS AND FOLLOWERS**

The Sale Comprises 57 In Milk &/Or In Calf Cows & Heifers, 46 In Calf Heifers (Due From August Onwards), 40 Bulling Heifers and 65 Yearlings & Heifer Calves. The Cows are Cubicle Housed and Milked through a Herringbone Parlour.

Milk Sales: 8,109 kgs 4.54% BF 4.54% P SCC=158

Together With

ARABLE & GRASSLAND MACHINERY: 2009 Sumo 3m Trailed Trio 3 c/w Headstock, Front Discs and Transport Kit and fitted with 2011 Opico 8 Air Drill, 2012 Hardi Navigator 3000 Trailed Sprayer c/w 24m Alloy Booms, Cousins V-Form 2.4m Subsoiler, 2010 Taarup 9142 Grass Rake, 2010 Tomahawk 8080 Bale Shredder, Reco Mengele SH40N Precision Chop Forage Harvester **TRACTOR:** 1986 Deutz Fahr 2WD Tractor **DAIRY EQUIPMENT:** Fabdec Stainless Steel Dari-Kool 6,000L Bulk Milk Tank c/w Fabdec Icebank **CUBICLES:** 126 IAE Super Cow Comfort Cubicles

TO BE SOLD BY AUCTION ON THE PREMISES

THURSDAY 16TH JUNE 2016

MACHINERY TO BE SOLD AT 11.00AM

DAIRY COWS TO BE SOLD AT 12.30PM

SATURDAY 18TH JUNE 2016

VINTAGE & COLLECTABLES AUCTION

In Association with the Midsummer Vintage Festival

Holt Lane, Ashby Magna, Lutterworth,

Leicestershire LE17 5NJ

Entries can be accepted and delivered up until the day before the sale between 8.30am and 5pm

Telephone: 01788 564749

7 – 11 Albert Street, Rugby, CV21 2RX

Email: dispersal.sales@howkinsandharrison.co.uk

GRASS KEEP

19.5 Acres of Cattle grazing - Ladbroke area
Call 02476697731

FOR SALE

Only 300 have passed over!

Double Race Handling System - Galvenised
Set on a dual axle static trailer, 12 x 10ft Hurdles
Onboard electric weighcrate
£4,000 plus Vat
Call 02476697731 (Tom)

FOR SALE

Pedigree Charolais Bulls
Ready to work, TB4 Member of HI Health, Not been pushed
Call Graham on 07860 765338

FOR SALE

Collie Puppies ready mid May, All dogs
Working parents both can be seen
01327 361696 / 07714 429362

FOR HIRE

Watson Grass Slitter Roll
Aeration and conditioner
£100 per day
Call 07768377713

PRIVATE TREATY

100 North Country Mule Ewe Lambs with lambs at foot
25 Texel x Ewe Lambs with lambs at foot
120 Mule Theaves with lambs at foot
60 LLeyn Ewe Lambs ran dry
Call Office on 02476 697731

FOR SALE

2003 Land Rover Defender Double Cab Pickup
200,000 Miles - County Spec
Owned from New - Farm Condition
£5,000 + Vat
Call Steve on 07775 628483

WANTED

Bale trailer twin axel
20ft plus and tidy
Call Robert on 01926 814731

WANTED

Slurry pump and/or stirrer
required for Cesspit setup
Call 02476 697731

FOR SALE

Very strong Huntaway Puppies
3 weeks old, pure bred
Call Parry Walters on 07713 641282

NORTHANTS LAND DRAINAGE CONTRACTORS LTD

Althorpe Park Station
East Haddon
Northamptonshire. NN6 8DH



Trench Excavations from 100mm to 500mm width

Laser Control on all Machines

Civil Engineering Contracts

All Types of Fencing

Road Drainage

Slurry Lagoons

Bulk Excavation & Site Clearance

Plastic, Clay & Concrete Pipes Laid

TRENCHING SPECIALISTS



Tel: 01604 770410 / 770320 Fax: 770406



J & B Gray
Pailton Pastures
Pailton

Rugby
CV23 0QN

store@jbgrayfarming.co.uk
07973 159903 / 01788 832652

**Your local family run grain storage solution whether it be
long term/ short term/ full loads/ part loads.**

**Also available – whole farm (stubble to stubble) contracting
operations.**

GPS controlled Spraying and Fertiliser application.

Farm Insurance Specialists

Call 01865 844994
Visit www.county-insurance.co.uk



County Insurance Services, County House, Civil Court, Lincoln
Lane, Nottingham, Nottingham, DN1 1QJ. County Insurance Services is
authorized and regulated by the Financial Services Authority. #144673



Your local, independent
farm fuels, heating oil &
lubricants supplier.



**Proud to be supporting
The Rugby Farmers Market**

01675 437557 | midlands@rix.co.uk | www.rix.co.uk



**FINISHING CATTLE?
GROWING CATTLE?
FEEDING SHEEP?
DO YOU WANT
HIGH PERFORMANCE
COST EFFECTIVE
FULLY ASSURED
AND
COMPLETE FEEDS?**



THEN CONTACT
BERRYSTOCK FEEDS
TEL: 01788 890320
E-MAIL: john@berryfieldsfarm.co.uk
www.berrystockfeeds.co.uk

BERRYFIELDS FARM
DAVENTRY
NN11 8NP

Rugby Farmers Mart Ltd

Forthcoming Sales 2016

27th June

Sale of Store Cattle

7th July

N.E.C RFM SPONSORS
LIVESTOCK SHOW

18th July

Sale of Store Cattle

29th July

First Annual Breeding Sheep Fair

Vendors who are wishing to sell stock please feel
free to contact:

Tom Wrench - 07774 723758

Steve Martin - 07960 085950

who will gladly make
A FREE ON FARM VISIT & VALUATION